

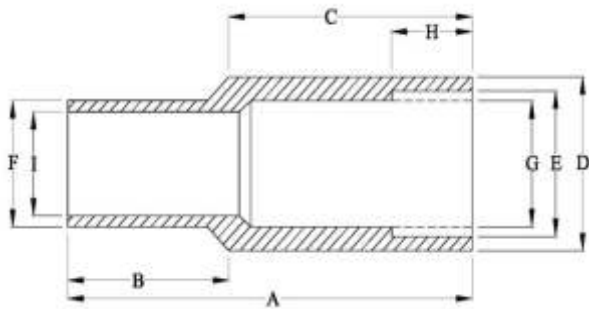

## SEAL POTS FOR ARMOUR



To Suit Diameter	Diameter (in mm)								
	A	B	C	D	E	F	G	H	I
6mm	16.5	6.5	10	12	11	8	9.5	3	6
3mm	40	10	30	3/8"	7	4.2	6.5	10	3
4.5mm	40	10	30	3/8"	7	6	6.5	10	4.6
6mm	40	10	30	3/8"	7	7.45	6.5	10	6
1.5mm	40	10	30	3/8"	7	3	6.5	10	5

Note : Seal Pots as per customer requirements are also available.